

L600PSFR Grill

Click on any circled item, then add the part to your cart. If it won't click, the part is not available. If the part is not available, please call us at: 888.988.4546

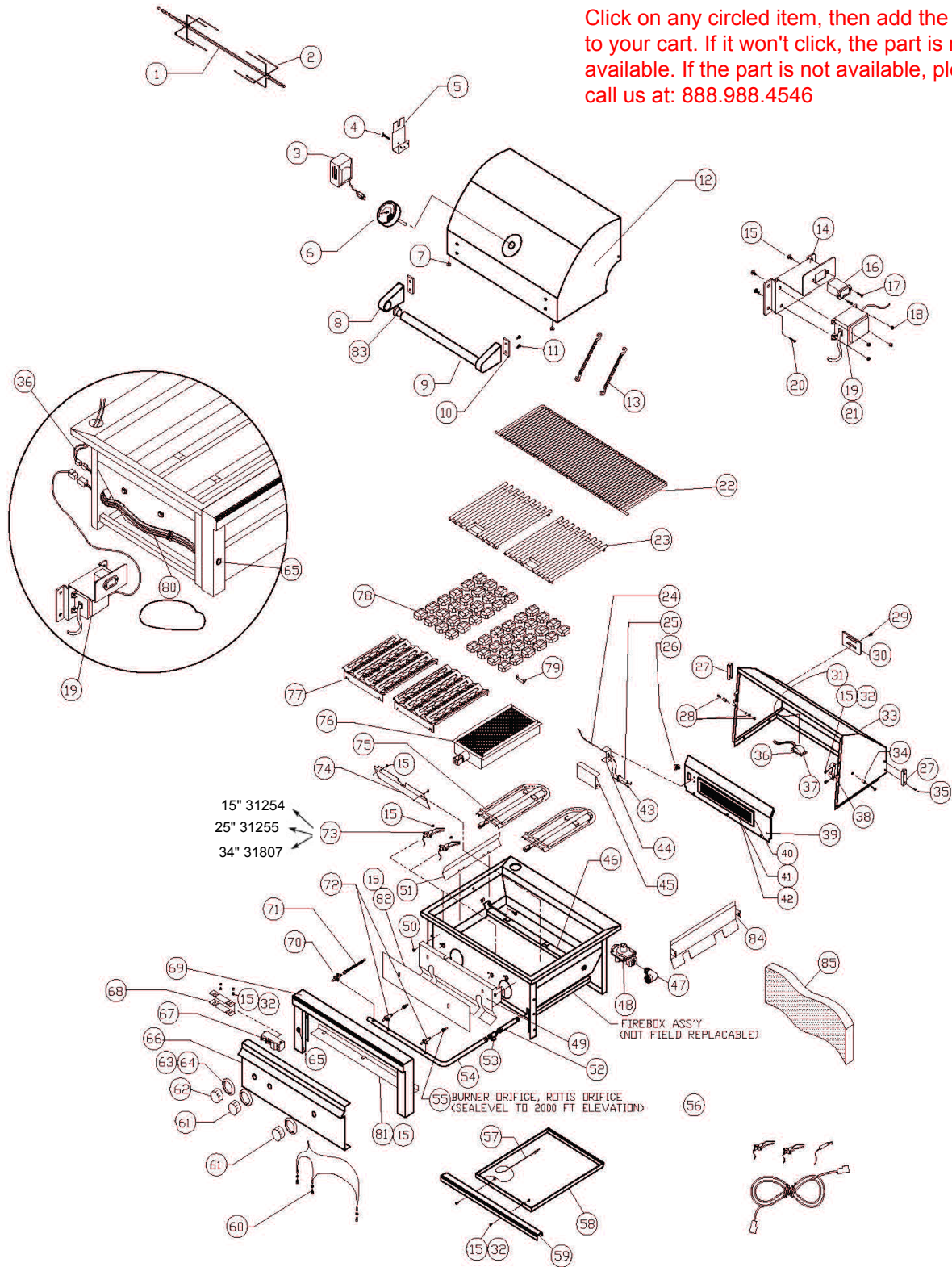

Item	Part No.	Name	Qty	Uom	NOTES
1	34074	SPIT ROD, L600	1	EA	
2	33813	SPIT FORK	2	EA	
3	33782	ROTISSERIE MOTOR 110V	1	EA	
4	33826	THUMB SCREW FOR MOTOR BRACKET	1	EA	
5	80659	MOTOR MOUNTING BRACKET ASSY	1	EA	
6	33558	THERMOMETER, WATERTIGHT	1	EA	
7	32477	HOOD BUMPER, .500 DIA	2	EA	
8	11117	END CAP FDR HOOD HANDLE	2	EA	
9	34075	HOOD HANDLE, L600	1	EA	
10	20016	INSULATOR, HOOD HANDLE	1	EA	
11	31601	BOLT, HEX HEAD, 1/4 - 20 X 7/8", SIS	4	EA	
12	80697	FRONT HOOD ASSY, L600	1	EA	
13	31780	EXTENSION SPRING	2	EA	
14	33827	TRANSFORMER MOUNTING BRACKET	1	EA	
15	14014	SCREW #8-32 x 3/8 PH TRUSS HEAD S/S	4	EA	
16	31879	BATTERY HOLDER	1	EA	
NI	90262	WIRE HARNESS, L600/L700 BATTERY PACK	1	EA	
17	30751	SCREW #6-32 X 1/2 PH FLAT HEAD	1	EA	
18	31238	NUT, # 8- 32 SIS	4	EA	
19	33525	TRANSFORMER	1	EA	
20	31013	SCREW, #8 X 1/2 PH TRUSS HD TYPE 'A'	4	EA	
21	80662	COMPLETE TRANSFORMER/BATTERY BKT ASSY	1	EA	
22	34071	WARMING SHELF, L600	1	EA	
23	34072	GRATE - 16 1/2" X 17 3/4", L600	2	EA	
24	20018	IR THERMOCOUPLE	1	EA	
25	31173	IR ELECTRODE	1	EA	

Item	Part No.	Name	Qty	Uom	NOTES
26	31795	IR BRASS ELBOW, 7/16-20 MALE THREAD	1	EA	
27	32468	HOOD STOP, ALL PRO	1	EA	
NI	32470	BUMPER FOR HOOD STOP, .750 DIA	1	EA	
28	14013	PIVOT SCREW, 114-20 X 1° HEX DRIVE	1	EA	
NI	14009	PIVOT SCREW NUT, HEX, 1/4-20 SIS	1	EA	
NI	14026	PIVOT WASHER, SPLIT LOCK, 1/4 SIS	1	EA	
29	14012	SCREW, 1/4-20 X 318 PH TRUSS HD, SIS	1	EA	
30	30417	IR ACCESS COVER	1	EA	
31	34065	LIGHT PANEL/REAR HOOD LINER, L600	1	EA	
32	14024	LOCK NUT, #8-32, SIS	1	EA	
33	80782	REAR HOOD ASSY, L700	1	EA	
34	34510	HOOD SPACER, ALL PRO SERIES	1	EA	
35	32469	SCREW/HOOD STOP-#8-32 X 1" PH TRUSS HD	1	EA	
36	80446	HOOD LIGHT ASS'Y, SINGLE W/LOW BULB	1	EA	
37	31979	BULB, REPLACEMENT, 10W HALOGEN	1	EA	
NI	32322	GLASS REPLACEMENT COVER W/ CLIP	1	EA	
38	10149	SPIT SADDLE	1	EA	
39	80700	IR PANEL ASSY, (INCLUDES BURNER), L600	1	EA	
40	32992	IR BURNER FRAME ONLY (MEDIUM-21 IN.)	1	EA	
41	32989	IR ROTIS, BURNER ONLY (MEDIUM-21 IN.)	1	EA	
42	32644	SCREW, #8-32 X 5/16 PH, FLAT HD	1	EA	
43	14018	SCREW, #6-32 X 1/4 PH, PAN HD	1	EA	
44	80753	IR IGNITER BRACKET	1	EA	
45	33136	IR IGNITER COVER 2010 <27', 36', 42', 54')	1	EA	

Item	Part No.	Name	Qty	Uom	NOTES
46	80751	BURNER HANGER, L600	1	EA	
47	13010	ELBOW, STREET, 1/2" 90 DEGREE-NG ONLY	1	EA	
NI	13054	ELBOW, 3/8" FLARE TO 1/2" FIP-LP ONLY	1	EA	
48	30781	REGULATOR 4/11 N/G ONLY	1	EA	
NI	13053	REGULATOR W/30' HOSE DOUBLE STAGE-LP	1	EA	
49	80750	HEAT SHIELD, L600	1	EA	
50	14023	NUT, COMBINATION (FDR HEAT SHIELD)	1	EA	
51	33751	BRIQUETTE HEAT DIVIDER	1	EA	
Not Shown	NOTE	(FOR 30" MODELS ONLY)		EA	
52	34267	PIPE EXTENSION 1/2 NPT X 5'	1	EA	
53	13029	'T' FITTING, 1/2 FPT	1	EA	
NI	34268	PIPE PLUG, 1/2 MPT, FDR 'T' FITTING	1	EA	
54	80733	MANIFOLD ASSY W/VALVES, L600 W/ROTIS	1	EA	
55	31880	ORIFICE NG #43	3	EA	
Not Shown	13020	ORIFICE BURNER LP (#54 SHORT)	3	EA	
Not Shown	13016	ORIFICE IR ROTIS, NG (#50 SHORT)	1	EA	
Not Shown	13021	ORIFICE IR ROTIS, LP (#57 SHORT)	1	EA	
56	90207	COMPLETE ELECTRODE KIT, L600, L700 IR	1	EA	
57	31031	ALTERNATE LIGHTING DEVICE, MATCH HOLDER	1	EA	
58	34057	DRIP PAN, L600	1	EA	
59	34058	DRIP PAN FASCIA, L600	1	EA	
60	80436	LED HARNESS ASSY, 36"/42"	1	EA	
61	90137	KNOB BURNER STAINLESS	2	EA	
62	90136	KNOB, ROTIS, STAINLESS	1	EA	
63	10001	BEZEL	3	EA	
64	31929	BEZEL SCREW, #6-32 X 1/8 PH PAN	6	EA	

Item	Part No.	Name	Qty	Uom	NOTES
65	80650	LIGHT SWITCH AND HARNESS	1	EA	
66	34060	FRONT PANEL, L600 W/ROTIS	1	EA	
67	31161	IGNITION MODULE - 4 SPARK	1	EA	
68	31398	IGNITER SHIELD	1	EA	
69	80699	BULLNOSE ASSY, L600	1	EA	
70	31772	IR BURNER VAL VE W I MICROSWITCH	1	EA	
71	31794	FLEX HOSE, 9 MM X 38' W I 7116 FITTING	1	EA	
72	34103	MAIN BURNER VALVE W/MICROSWITCH	1	EA	
73	31254	ELECTRODE W / 15" WIRE (SEE ALSO #56)	1	EA	
73	31255	ELECTRODE W / 25" WIRE (SEE ALSO #56)	1	EA	
73	31807	ELECTRODE W/34" WIRE	1	EA	
74	34079	GAS DEFLECTOR, L600	1	EA	
75	33750	TUBULAR BURNER	2	EA	
76	33943	PROSEAR BURNER	1	EA	
77	80743	BRIQUETTE TRAY W/BRIQUETTES AND CLIPS (3 COMPLETE ROWS)	1	EA	
78	90183	BRIQUETTES 24 PER BOX	1	EA	
79	34246	BRIQUETTE HOLD DOWN CLIP	1	EA	
80	80648	MAIN POWER HARNESS, L500	1	EA	
81	34165	BULLNOSE FILLER PLATE, L600	1	EA	
82	34179	INSULATION COVER PLATE, L600	1	EA	
83	31738	INSULATING BUSHING, HOOD HANDLE	1	EA	
84	33894	FIREBOX PARTITION	1	EA	
85	34253	FIREBOX INSULATION STRIP - 6" X 36" X 1 1/2"	1	EA	