

L700PSR Parts Breakdown

Click on any circled item, then add the part to your cart. If it won't click, the part is not available. If the part is not available, please call us at: 888.988.4546

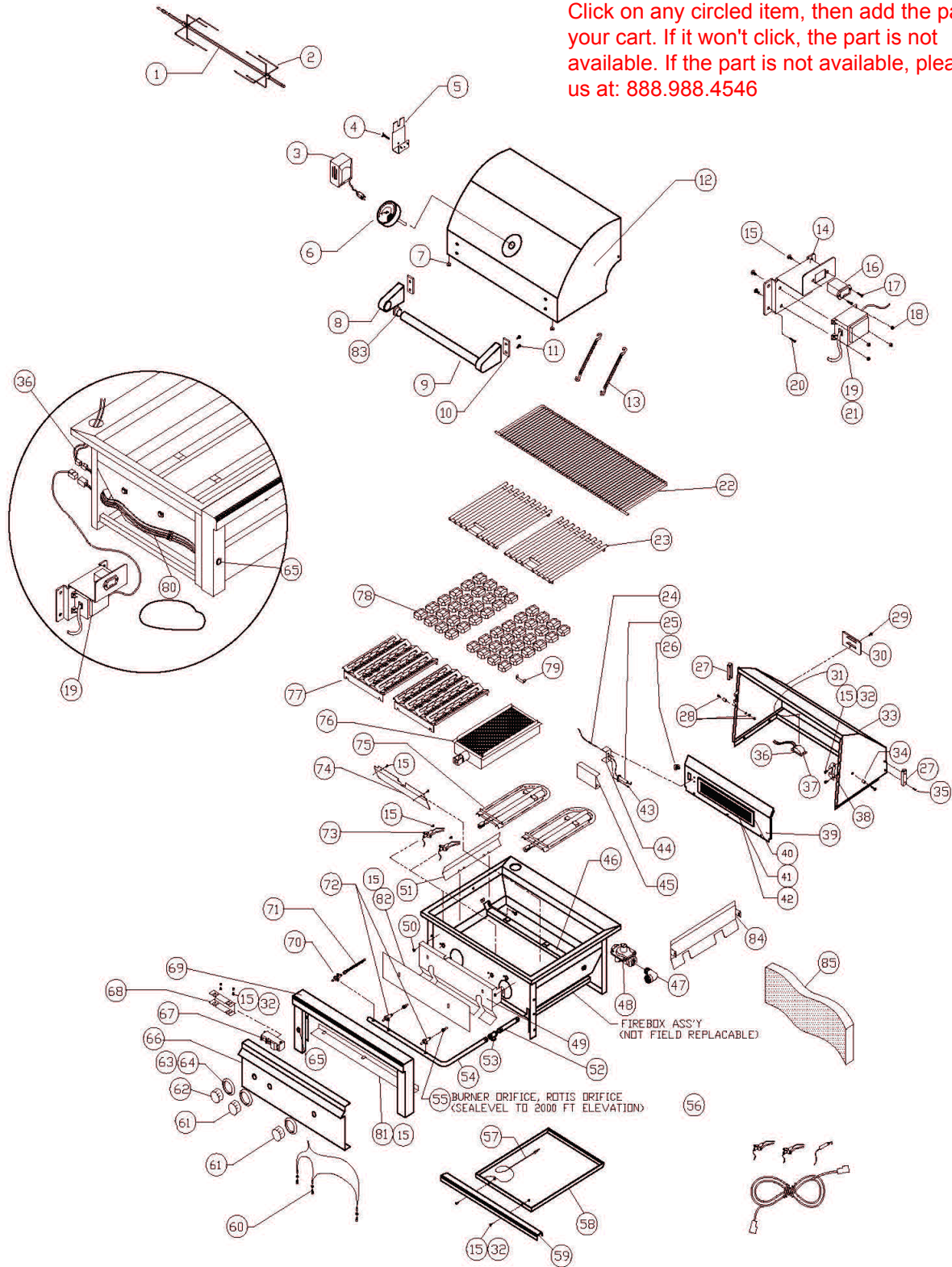

| Item | Part No. | Name | Qty | Uom | NOTES |
|------|----------|---------------------------------------|-----|-----|-------|
| 1 | 34604 | SPIT ROD, L700 | 1 | EA | |
| 2 | 33813 | SPIT FORK | 2 | EA | |
| 3 | 33782 | ROTISSERIE MOTOR 110V | 1 | EA | |
| 4 | 33826 | THUMB SCREW FOR MOTOR BRACKET | 1 | EA | |
| 5 | 80659 | MOTOR MOUNTING BRACKET ASSY | 1 | EA | |
| 6 | 33558 | THERMOMETER, WATERTIGHT | 1 | EA | |
| 7 | 32477 | HOOD BUMPER, .500 DIA | 2 | EA | |
| 8 | 11117 | END CAP FDR HOOD HANDLE | 2 | EA | |
| 9 | 34605 | HOOD HANDLE, L700 | 1 | EA | |
| 10 | 20016 | INSULATOR, HOOD HANDLE | 1 | EA | |
| 11 | 31601 | BOLT, HEX HEAD, 1/4 - 20 X 7/8", SIS | 4 | EA | |
| 12 | 80781 | FRONT HOOD ASSY, L700 | 1 | EA | |
| 13 | 31780 | EXTENSION SPRING | 2 | EA | |
| 14 | 33827 | TRANSFORMER MOUNTING BRACKET | 1 | EA | |
| 15 | 14014 | SCREW #8-32 x 3/8 PH TRUSS HEAD S/S | 4 | EA | |
| 16 | 31879 | BATTERY HOLDER | 1 | EA | |
| NI | 90262 | WIRE HARNESS, L600/L700 BATTERY PACK | 1 | EA | |
| 17 | 30751 | SCREW #6-32 X 1/2 PH FLAT HEAD | 1 | EA | |
| 18 | 31238 | NUT, # 8- 32 SIS | 4 | EA | |
| 19 | 33525 | TRANSFORMER | 1 | EA | |
| 20 | 31013 | SCREW, #8 X 1/2 PH TRUSS HD TYPE 'A' | 4 | EA | |
| 21 | 80662 | COMPLETE TRANSFORMER/BATTERY BKT ASSY | 1 | EA | |
| 22 | 34601 | WARMING SHELF, L700 | 1 | EA | |
| 23 | 33779 | GRATE 13 1/2' X 17 - 3/4' , L500 | 2 | EA | |
| 23 | 34602 | GRATE - 12" X 17 3/4", L700 CENTER | 1 | EA | |
| 24 | 20018 | IR THERMOCOUPLE | 1 | EA | |

| Item | Part No. | Name | Qty | Uom | NOTES |
|------|----------|--|-----|-----|-------|
| 25 | 31173 | IR ELECTRODE | 1 | EA | |
| 26 | 31795 | IR BRASS ELBOW, 7/16-20 MALE THREAD | 1 | EA | |
| 27 | 32468 | HOOD STOP, ALL PRO | 1 | EA | |
| NI | 32470 | BUMPER FOR HOOD STOP, .750 DIA | 1 | EA | |
| 28 | 14013 | PIVOT SCREW, 114-20 X 1° HEX DRIVE | 1 | EA | |
| NI | 14009 | PIVOT SCREW NUT, HEX, 1/4-20 SIS | 1 | EA | |
| NI | 14026 | PIVOT WASHER, SPLIT LOCK, 1/4 SIS | 1 | EA | |
| 29 | 14012 | SCREW, 1/4-20 X 3/8 PH TRUSS HD, SIS | 1 | EA | |
| 30 | 30417 | IR ACCESS COVER | 1 | EA | |
| 31 | 34575 | LIGHT PANEL/REAR HOOD LINER, L700 | 1 | EA | |
| 32 | 14024 | LOCK NUT, #8-32, SIS | 1 | EA | |
| 33 | 80782 | REAR HOOD ASSY, L700 | 1 | EA | |
| 34 | 34510 | HOOD SPACER, ALL PRO SERIES | 1 | EA | |
| 35 | 32469 | SCREW /HOOD STOP-#8-32 X 1" PH TRUSS HD | 1 | EA | |
| 36 | 80446 | HOOD LIGHT ASS'Y, SINGLE W/LOW BULB | 1 | EA | |
| 37 | 31979 | BULB, REPLACEMENT, 10W HALOGEN | 1 | EA | |
| NI | 32322 | GLASS REPLACEMENT COVER W/ CLIP | 1 | EA | |
| 38 | 10149 | SPIT SADDLE | 1 | EA | |
| 39 | 80784 | IR PANEL ASSY, (INCLUDES BURNER), L700 | 1 | EA | |
| 40 | 32993 | IR BURNER FRAME ONLY (LARGE-28 IN.) | 1 | EA | |
| 41 | 32990 | IR ROTIS. BURNER ONLY (LARGE-28 IN.) | 1 | EA | |
| 42 | 32644 | SCREW, #8-32 X 5/16 PH, FLAT HD | 1 | EA | |
| 43 | 14018 | SCREW, #6-32 X 1/4 PH, PAN HD | 1 | EA | |
| 44 | 80753 | IR IGNITER BRACKET | 1 | EA | |

| Item | Part No. | Name | Qty | Uom | NOTES |
|--------------|----------|---|-----|-----|-------|
| 45 | 33136 | IR IGNITER COVER 2010 <27', 36', 42', 54') | 1 | EA | |
| 46 | 80803 | BURNER HANGER, L700 | 1 | EA | |
| 47 | 13010 | ELBOW, STREET, 1/2" 90 DEGREE-NG ONLY | 1 | EA | |
| NI | 13054 | ELBOW, 3/8" FLARE TO 1/2" FIP-LP ONLY | 1 | EA | |
| 48 | 30781 | REGULATOR 4/11 N/G ONLY | 1 | EA | |
| NI | 13053 | REGULATOR W/30' HOSE DOUBLE STAGE-LP | 1 | EA | |
| 49 | 80802 | HEAT SHIELD, L700 | 1 | EA | |
| 50 | 14023 | NUT, COMBINATION (FDR HEAT SHIELD) | 1 | EA | |
| 51 | 33751 | BRIQUETTE HEAT DIVIDER | 1 | EA | |
| Not Shown | NOTE | (FOR 30" MODELS ONLY) | | EA | |
| 52 | 34267 | PIPE EXTENSION 1/2 NPT X 5' | 1 | EA | |
| 53 | 13029 | 'T' FITTING, 1/2 FPT | 1 | EA | |
| NI | 34268 | PIPE PLUG, 1/2 MPT, FDR 'T' FITTING | 1 | EA | |
| 54 | 80786 | MANIFOLD ASSY W/VALVES, L700 W/ROTIS | 1 | EA | |
| 55 | 31880 | ORIFICE NG #43 | 3 | EA | |
| Not Shown | 13020 | ORIFICE BURNER LP (#54 SHORT) | 3 | EA | |
| Not Shown | 13016 | ORIFICE IR ROTIS, NG (#50 SHORT) | 1 | EA | |
| Not Shown | 13021 | ORIFICE IR ROTIS, LP (#57 SHORT) | 1 | EA | |
| 56 | 90207 | COMPLETE ELECTRODE KIT, L600, L700 IR | 1 | EA | |
| 57 | 31031 | ALTERNATE LIGHTING DEVICE, MATCH HOLDER | 1 | EA | |
| 58 | 34567 | DRIP PAN, L700 | 1 | EA | |
| 59 | 34568 | DRIP PAN FASCIA, L700 | 1 | EA | |
| 60 | 80436 | LED HARNESS ASSY, 36"/42" | 1 | EA | |
| 61 | 90137 | KNOB BURNER STAINLESS | 2 | EA | |
| 62 | 90136 | KNOB, ROTIS, STAINLESS | 1 | EA | |
| 63 | 10001 | BEZEL | 3 | EA | |

| Item | Part No. | Name | Qty | Uom | NOTES |
|--------------|----------|---|-----|-----|-------|
| 64 | 31929 | BEZEL SCREW, #6-32 X 1/8 PH PAN | 6 | EA | |
| 65 | 80650 | LIGHT SWITCH AND HARNESS | 1 | EA | |
| 66 | 34570 | FRONT PANEL, L700 W/ROTIS | 1 | EA | |
| 67 | 31161 | IGNITION MODULE - 4 SPARK | 1 | EA | |
| 68 | 31398 | IGNITER SHIELD | 1 | EA | |
| 69 | 80783 | BULLNOSE ASSY, L700 | 1 | EA | |
| 70 | 31772 | IR BURNER VAL VE W I MICROSWITCH | 1 | EA | |
| 71 | 31794 | FLEX HOSE, 9 MM X 38' W I 7116 FITTING | 1 | EA | |
| 72 | 34103 | MAIN BURNER VALVE W/MICROSWITCH | 1 | EA | |
| 73 | 31254 | ELECTRODE W / 15" WIRE (SEE ALSO #56) | 1 | EA | |
| 73 | 31255 | ELECTRODE W / 25" WIRE (SEE ALSO #56) | 1 | EA | |
| 73 | 31807 | ELECTRODE W/34" WIRE | 1 | EA | |
| 74 | 34578 | GAS DEFLECTOR, L700 | 1 | EA | |
| 75 | 33750 | TUBULAR BURNER | 2 | EA | |
| 76 | 33943 | PROSEAR BURNER | 1 | EA | |
| 77 | 80743 | BRIQUETTE TRAY W/BRIQUETTES AND CLIPS (3 COMPLETE ROWS) | 1 | EA | |
| 77 | 80744 | BRIQUETTE TRAY W / BRIQUETTES AND CLIPS (4 COMPLETE ROWS) | 1 | EA | |
| 78 | 90183 | BRIQUETTES 24 PER BOX | 1 | EA | |
| 79 | 34246 | BRIQUETTE HOLD DOWN CLIP | 1 | EA | |
| 80 | 80648 | MAIN POWER HARNESS, L500 | 1 | EA | |
| 81 | 33540 | BULLNOSE FILLER PLATE, L700 | 1 | EA | |
| 82 | 34582 | INSULATION COVER PLATE, L700 | 1 | EA | |
| 83 | 31738 | INSULATING BUSHING, HOOD HANDLE | 1 | EA | |
| 84 | 33894 | FIREBOX PARTITION | 1 | EA | |
| Not Shown | NOTE | (ONLY FOR 30" AND 36" UNITS) | | EA | |

| Item | Part No. | Name | Qty | Uom | NOTES |
|------|----------|---|-----|-----|-------|
| 85 | 34658 | FIREBOX INSULATION STRIP - 6" X 42" X 1 1/2" | 1 | EA | |